

THIS IS ISSUED IN STRICT CONFIDENCE ON THE CONDITION THAT IT IS NOT USED AS A BASIS FOR MANUFACTURE OR SALE, AND THAT IT IS NOT COPIED, REPRINTED OR DISCLOSED TO ANY THIRD PARTY WITHOUT THE PRIOR WRITTEN CONSENT OF MIN-E-CON

UNLESS OTHERWISE SPECIFIED ALL DIMENSIONS ARE IN INCHES DRAWING STANDARDS ARE PER ANSI Y14.5M-1982

THIRD ANGLE PROJECTION

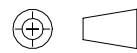

REVISIONS				
ECO	REV	DESCRIPTION	DATE	APPROVED
	A	RELEASE	7/30/09	WC

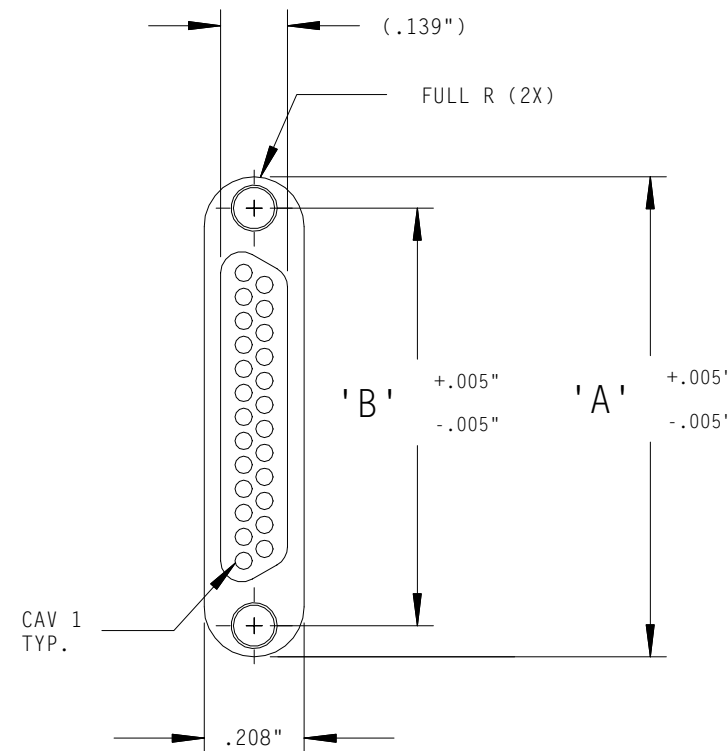
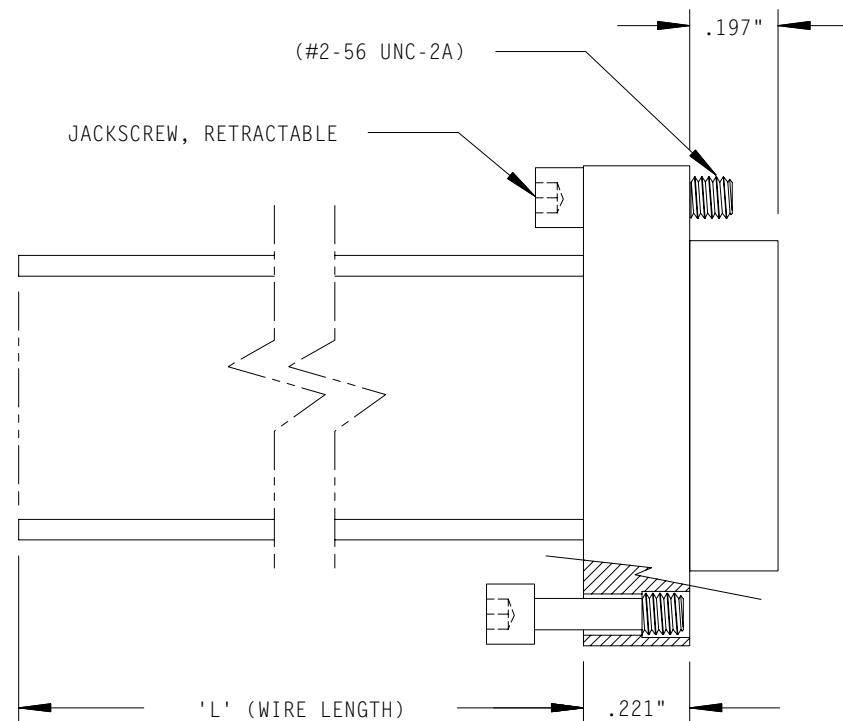

CONN SIZE	A	B
9	0.600	0.470
15	0.750	0.620
21	0.900	0.770
25	1.000	0.870
31	1.150	1.020
37	1.300	1.170

NOTES:

- ALL TOLERANCES ±.010" UNLESS OTHERWISE SPECIFIED
- CONNECTOR INTERFACE PER MIL-DTL-83513/8 (PLUG CLASS P CRIMP TYPE)
- MATERIAL:
 - A) INSULATOR: POLYPHENYLENE SULFIDE (RYTON).
 - B) SHELL: ALUMINUM ALLOY 6061-T6 HARD ANODIZED COLOR: BLACK.
 - C) CONTACT:
 - 1) BASE MATERIAL: BERYLLIUM COPPER PER C17410
 - 2) PLATING: GOLD OVER NICKEL, 50 TO 150 MICROINCHES PER MIL-G-45204, TYPE II, GRADE C, CLASS 1.
 - D) EPOXY: HI-TEMPERATURE, 200°C.
 - E) WIRE: AS SPECIFIED BY PART NUMBER
 - F) JACKSCREW: 300 SERIES STAINLESS STEEL, PASSIVATED.
- CONNECTOR RATED TO 200°C.

PART NUMBER CONSTRUCTION

DNBR-XX P X X X - XX.Ø H /Ø1

OF CONTACTS
9, 15, 21, 25, 31, 37

CONTACT TYPE
P = PIN

WIRE SIZE (AWG)
4 = 24, 6 = 26, 8 = 28

WIRE TYPE (REF M16878)
E = 7 STRAND TYPE 'E'
F = 7 STRAND TYPE 'ET'
G = 19 STRAND TYPE 'E'
H = 19 STRAND TYPE 'ET'

MODIFICATION CODE
/01 = HI-TEMP (200C) CONNECTOR

HARDWARE
H = #2-56 RETRACTABLE JACKSCREW

WIRE LENGTH (INCHES)
6.0 MIN.
120.0 MAX.
INCREMENTS OF 6.0 INCHES

INSULATION COLOR
1 = ALL WHITE
2 = ALL YELLOW
5 = COLOD CODED PER MIL-STD 681 SYSTEM 1

INTENDED USE CUSTOMER USE			17312 EASTMAN IRVINE, CA 92614			
REFERENCE			DWG TITLE CONN, PLUG., DNBR SERIES LOW PROFILE			
DRAWN CHARETTE	SIGNATURES	DATE 7/30/09	SIZE B	FSCM NO. 54455	DWG NO. 00-005-0019	REV A
CHECKED WC		7/30/09	SCALE NONE		SHEET 1 of 1	
APPROVED WC		7/30/09				