

STRAIGHT THROUGH NPT – Sizes

- Protection Rating: IP68; NEMA 4X
- Pressure Rating: 5 Bar; 70psi
- Seal Rings Factory Installed on Nickel Plated Brass Cord Grips
- Order Seal Rings Separately for Polyamide Cord Grips – See Page 62
- Order Locknuts Separately – See Page 60
- Standard Colors: Light Gray or Black

Polyamide (PA)



with Neoprene (NEP) Sealing Insert

Nickel Plated Brass (NPB)



with Neoprene (NEP) Sealing Insert

MATERIAL SPECIFICATIONS:		
Body	Polyamide (PA)	Nickel Plated Brass (NPB)
Insert	Neoprene (NEP)	Neoprene (NEP)
Seal Ring	Polyethylene (PET)	Perbunan (PRB)
TEMPERATURE RANGE:		
Body	-20 to 100°C (-4 to 212°F)	-40 to 300°C (-40 to 572°F)
Insert	-20 to 80°C (-4 to 176°F)	-20 to 80°C (-4 to 176°F)
Seal Ring	-20 to 100°C (-4 to 212°F)	-20 to 120°C (-4 to 248°F)
INSERT COLOR:	Black	Black

Type	Std. Pk.	Cable Dia. mm (in.)	Cat. No.		Cable Dia. mm (in.)	Cat. No.
			Light Gray	Black		
NPT 3/8" - J*** ** NEP 7.0	50	3.0 - 7.0 (.12-.28)	22100.2	22105.1	2.0 - 6.0 (.08-.24)	22404.6
NPT 3/8" - J*** ** NEP 10.0	50	5.0 - 10.0 (.20-.39)	22090.2	22095.1	4.0 - 8.0 (.16-.31)	22400.6
NPT 1/2" - J*** ** NEP 12.0	50	7.0 - 12.0 (.28-.47)	22101.2	22106.1	5.0 - 9.0 (.20-.35)	22405.6
NPT 1/2" - J*** ** NEP 14.0	50	10.0 - 14.0 (.39-.55)	22091.2	22096.1	6.0 - 12.0 (.24-.47)	22401.6
NPT 3/4" - J*** ** NEP 16.0	25	9.0 - 16.0 (.35-.63)	22102.2	22107.1	9.0 - 16.0 (.35-.63)	22406.6
NPT 3/4" - J*** ** NEP 18.0	25	13.0 - 18.0 (.51-.71)	22092.2	22097.1	13.0 - 18.0 (.51-.71)	22402.2
NPT 1" - J*** ** NEP 20.0	5	12.0 - 20.0 (.47-.79)	22103.2	22108.1	12.0 - 20.0 (.47-.79)	22407.6
NPT 1" - J*** ** NEP 25.0	5	18.0 - 25.0 (.71-.98)	22093.2	22098.1	18.0 - 25.0 (.71-.98)	22403.6

** Add Body Color – LG for Light Gray, BK for Black

 ** Add Body Material – PA for Polyamide, NB for Nickel Plated Brass

Polyamide (PA)

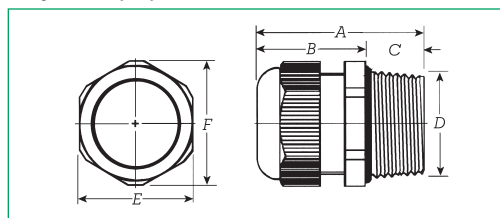

Dimensions: mm (in.) Polyamide (PA)

Size	A	B	C	D	E	F
NPT 3/8"	44.2 (1.74)	29.0 (1.14)	15.0 (.59)	17.2 (.68)	22.0	24.3 (.96)
NPT 1/2"	46.0 (1.81)	31.3 (1.23)	15.0 (.59)	21.3 (.84)	27.0	29.6 (1.17)
NPT 3/4"	51.6 (2.03)	36.7 (1.44)	15.0 (.59)	26.7 (1.05)	33.0	36.1 (1.42)
NPT 1"	55.0 (2.17)	51.0 (2.01)	15.0 (.59)	33.3 (1.31)	42.0	46.5 (1.83)

Nickel Plated Brass (NPB)

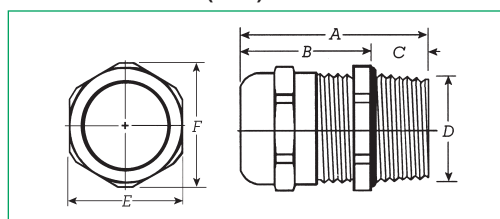

Dimensions: mm (in.) Nickel Plated Brass (NPB)

Size	A	B	C	D	E	F
NPT 3/8"	37.0 (1.46)	23.0 (.91)	15.0 (.59)	17.2 (.68)	17.0	18.3 (.72)
NPT 1/2"	40.0 (1.57)	27.0 (1.06)	15.0 (.59)	21.3 (.84)	22.0	24.0 (.94)
NPT 3/4"	40.5 (1.59)	28.0 (1.10)	18.0 (.71)	26.7 (1.05)	30.0	33.5 (1.32)
NPT 1"	51.5 (2.03)	33.5 (1.32)	18.0 (.71)	33.3 (1.31)	40.0	43.5 (1.71)

STRAIGHT THROUGH NPT – Sizes

- Protection Rating: IP68; NEMA 4X
- Pressure Rating: 10 Bar; 140psi
- Seal Rings Factory Installed on Nickel Plated Brass Cord Grips
- Order Seal Rings Separately for Polyvinylidene Cord Grips – See Page 62
- Order Locknuts Separately – See Page 60
- Standard Colors: Opaque or Black
- Other Tubular Sealing Insert Materials available

Polyvinylidene (PVDF)

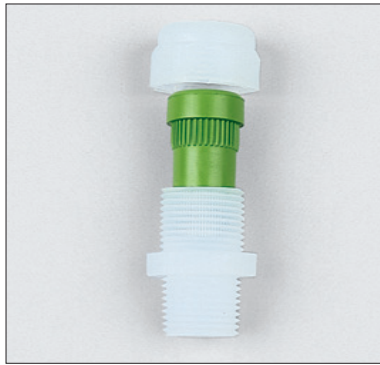

with Polyvinylchloride (PVC) Tubular Sealing Insert

Nickel Plated Brass (NPB)



with Polyvinylchloride (PVC) Tubular Sealing Insert

MATERIAL SPECIFICATIONS:

Body

Polyvinylidene (PVDF)

Nickel Plated Brass (NPB)

Insert

Polyvinylchloride (PVC)

Polyvinylchloride (PVC)

Seal Ring

Polyethylene (PET)

Perbunan (PRB)

TEMPERATURE RANGE:

Body

-40 to 150°C (-40 to 302°F)

-40 to 300°C (-40 to 572°F)

Insert

-20 to 80°C (-4 to 176°F)

-20 to 80°C (-4 to 176°F)

Seal Ring

-20 to 100°C (-4 to 212°F)

-20 to 120°C (-4 to 248°F)

INSERT COLOR:

Various

Various

Type	Std. Pk.	Cable Dia.		Cat. No.		Cable Dia.		Cat. No.
		mm	(in.)	Opaque	Black	mm	(in.)	
NPT 3/8" - P*** **PVC 8.0	50	5.0 - 8.0	(.20-.31)	20860.4	20870.5	5.0 - 8.0	(.20-.31)	20900.6
NPT 3/8" - P*** **PVC 10.5	50	7.0 - 10.5	(.28-.41)	20861.4	20871.5	7.0 - 10.5	(.28-.41)	20901.6
NPT 1/2" - P*** **PVC 13.0	50	9.0 - 13.0	(.35-.51)	20862.4	20872.5	9.0 - 13.0	(.35-.51)	20903.6
NPT 1/2" - P*** **PVC 15.5	50	11.5 - 15.5	(.45-.61)	20863.4	20873.5	11.5 - 15.5	(.45-.61)	20904.6
NPT 3/4" - P*** **PVC 18.0	25	14.0 - 18.0	(.55-.71)	20864.4	20874.5	14.0 - 18.0	(.55-.71)	20906.6
NPT 3/4" - P*** **PVC 20.5	25	17.0 - 20.5	(.67-.81)	20865.4	20875.5	17.0 - 20.5	(.67-.81)	20907.6
NPT 1" - P*** **PVC x.x	5	-	-	-	-	20.0 - 25.0	(.79-.98)	20908.6
NPT 1" - P*** **PVC x.x	5	-	-	-	-	24.0 - 28.0	(.94-1.10)	20909.6

- ** Add Body Color – OP for Opaque, BK for Black
- ** Add Body Material – PF for Polyvinylidene, NB for Nickel Plated Brass

Polyvinylidene (PVDF)

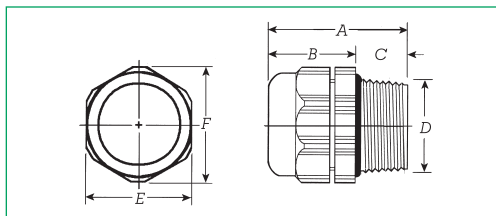

Dimensions: mm (in.) Polyvinylidene (PVDF)

Size	A	B	C	D	E	F
NPT 3/8"	41.5 (1.63)	28.5 (1.12)	13.0 (.51)	17.2 (.68)	22.0	24.4 (.96)
NPT 1/2"	44.5 (1.75)	28.5 (1.12)	16.0 (.63)	21.3 (.84)	24.0	26.7 (1.05)
NPT 3/4"	48.5 (1.91)	32.5 (1.28)	16.0 (.63)	26.7 (1.05)	33.0	36.5 (1.44)

Nickel Plated Brass (NPB)

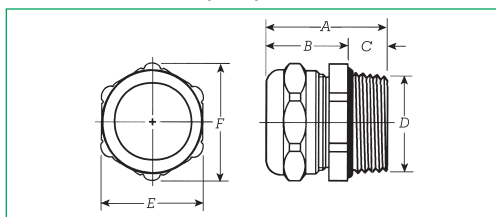

Dimensions: mm (in.) Nickel Plated Brass (NPB)

Size	A	B	C	D	E	F
NPT 3/8"	41.0 (1.61)	28.0 (1.10)	13.0 (.51)	17.2 (.68)	20.0	22.2 (.87)
NPT 1/2"	44.0 (1.73)	28.0 (1.10)	16.0 (.63)	21.3 (.84)	24.0	26.7 (1.05)
NPT 3/4"	50.0 (1.97)	34.0 (1.34)	16.0 (.63)	26.7 (1.05)	30.0	33.5 (1.32)
NPT 1"	58.0 (2.28)	38.0 (1.50)	20.0 (.79)	33.3 (1.31)	40.0	43.5 (1.71)