

STRAIGHT-THROUGH Nickel Plated Brass (NPB)



- Protection Rating: IP68; NEMA 4X
- Pressure Rating: 10 Bar; 140 psi
- Selection of 3 Insert Materials
- Optional 15mm (.59 in.) Long External Thread
- Seal Ring Factory Installed
- Order Locknuts Separately

MATERIAL SPECIFICATIONS:

Body

Nickel Plated Brass (NPB)

Insert

Polyvinylchloride (PVC)

Seal Ring

Perbunan (PRB)

TEMPERATURE RANGE:

Body

-40 to 300°C (-40 to 572°F)

Insert

-20 to 80°C (-4 to 176°F)

Seal Ring

-20 to 120°C (-4 to 248°F)

INSERT COLOR:

Various

Nickel Plated Brass (NPB)



with Polyvinylchloride (PVC)
Tubular Sealing Insert

Type	Mtg. Hole Dia. mm. (in.)	Std. Pk.	Cable Dia.		Sealing Insert		Cat. No.
			mm.	(in.)	Color		
PG7-PSNPB ***	6.5	50	4.0 - 6.5	(.16-.26)	Yellow	20150.6	
PG9-PSNPB ***	8.0	50	5.0 - 8.0	(.20-.31)	Gray	20152.6	
PG9-PSNPB ***	9.5	50	6.5 - 9.5	(.26-.37)	Black	20153.6	
PG11-PSNPB ***	8.0	50	5.0 - 8.0	(.20-.31)	Gray	20155.6	
PG11-PSNPB ***	9.5	50	6.5 - 9.5	(.26-.37)	Black	20156.6	
PG11-PSNPB ***	10.5	50	7.0 - 10.5	(.28-.41)	Green	20157.6	
PG13.5-PSNPB ***	9.5	50	6.5 - 9.5	(.26-.37)	Black	20160.6	
PG13.5-PSNPB ***	10.5	50	7.0 - 10.5	(.28-.41)	Green	20161.6	
PG13.5-PSNPB ***	13.0	50	9.0 - 13.0	(.35-.51)	Red	20162.6	
PG16-PSNPB ***	10.5	25	7.0 - 10.5	(.28-.41)	Green	20166.6	
PG16-PSNPB ***	13.0	25	9.0 - 13.0	(.35-.51)	Red	20167.6	
PG16-PSNPB ***	15.5	25	11.5 - 15.5	(.45-.61)	White	20168.6	
PG21-PSNPB ***	15.5	25	11.5 - 15.5	(.45-.61)	White	20171.6	
PG21-PSNPB ***	18.0	25	14.0 - 18.0	(.55-.71)	Blue	20172.6	
PG21-PSNPB ***	20.5	25	17.0 - 20.5	(.67-.81)	Brown	20173.6	
PG29-PSNPB ***	25.0	20	20.0 - 25.0	(.79-.98)	Orange	20177.6	
PG29-PSNPB ***	28.0	20	24.0 - 28.0	(.94-1.10)	Light Yellow	20178.6	
PG36-PSNPB ***	32.0	10	27.0 - 32.0	(1.06-1.26)	Dark Gray	20179.6	
PG36-PSNPB ***	36.0	10	32.0 - 36.0	(1.26-1.42)	Rose	20181.6	
PG42-PSNPB ***	40.0	5	36.0 - 40.0	(1.42-1.57)	White	20182.6	
PG48-PSNPB ***	44.0	5	39.0 - 44.0	(1.54-1.73)	White	20183.6	

*** Add Insert Material – PVC for Polyvinylchloride, STP for Santoprene, SIL for Silicone

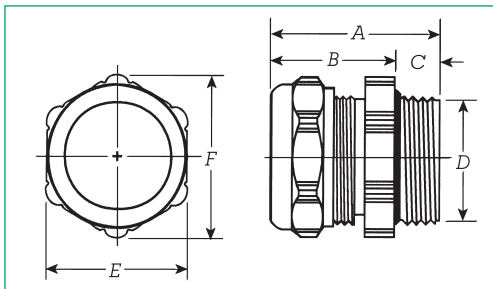

Dimensions: mm (in.) Nickel Plated Brass (NPB)

Size	A	B	C	D	E	F
PG7	25.0 (.98)	20.0 (.79)	5.0 (.20)	12.5 (.49)	14.0	15.5 (.61)
PG9	26.0 (1.02)	20.0 (.79)	6.0 (.24)	15.2 (.60)	17.0	18.9 (.74)
PG11	26.0 (1.02)	20.0 (.79)	6.0 (.24)	18.6 (.73)	20.0	22.2 (.87)
PG13.5	27.5 (1.08)	21.0 (.83)	6.5 (.26)	20.4 (.80)	22.0	24.4 (.96)
PG16	27.5 (1.08)	21.0 (.83)	6.5 (.26)	22.5 (.89)	24.0	26.7 (1.05)
PG21	32.0 (1.26)	25.0 (.98)	7.0 (.28)	28.3 (1.11)	30.0	33.5 (1.32)
PG29	35.0 (1.38)	27.0 (1.06)	8.0 (.31)	37.0 (1.46)	40.0	43.5 (1.71)
PG36	37.0 (1.46)	28.0 (1.10)	9.0 (.35)	47.0 (1.85)	50.0	54.0 (2.24)
PG42	40.0 (1.57)	30.0 (1.18)	10.0 (.39)	54.0 (2.13)	57.0	61.0 (2.40)
PG48	40.0 (1.57)	30.0 (1.18)	10.0 (.39)	59.3 (2.33)	64.0	69.0 (2.72)

Nickel Plated Brass (NPB)



**with Santoprene (STP)
Tubular Sealing Insert**

Nickel Plated Brass (NPB)
Santoprene (STP)
Perbunan (PRB)

-40 to 300°C (-40 to 572°F)
-60 to 125°C (-65 to 257°F)
-20 to 120°C (-4 to 248°F)

Beige

Cable Dia.		Cat. No.
mm	(in.)	
-	-	-
-	-	-
6.5 - 9.5	(.26-.37)	20431.6
-	-	-
-	-	-
7.0 - 10.5	(.28-.41)	20432.6
6.5 - 9.5	(.26-.37)	20433.6
7.0 - 10.5	(.28-.41)	20434.6
9.0 - 13.0	(.35-.51)	20435.6
7.0 - 10.5	(.28-.41)	20438.6
9.0 - 13.0	(.35-.51)	20439.6
11.5 - 15.5	(.45-.61)	20440.6
11.5 - 15.5	(.45-.61)	20441.6
14.0 - 18.0	(.55-.71)	20442.6
17.0 - 20.5	(.67-.81)	20443.6
-	-	-
24.0 - 28.0	(.94-1.10)	20444.6
30.0 - 34.0	(1.18-1.34)	20445.6
32.0 - 36.0	(1.26-1.42)	20447.6
-	-	-
-	-	-

Nickel Plated Brass (NPB)



**with Silicone (SIL)
Tubular Sealing Insert**

Nickel Plated Brass (NPB)
Silicone (SIL)
Silicone (SIL)

-40 to 300°C (-40 to 572°F)
-60 to 200°C (-65 to 392°F)
-60 to 200°C (-65 to 392°F)

Opaque

Cable Dia.		Cat. No.
mm	(in.)	
-	-	-
-	-	-
6.5 - 9.5	(.26-.37)	20471.6
-	-	-
6.5 - 9.5	(.26-.37)	20473.6
7.0 - 10.5	(.28-.41)	20474.6
6.5 - 9.5	(.26-.37)	20476.6
7.0 - 10.5	(.28-.41)	20477.6
9.0 - 13.0	(.35-.51)	20478.6
7.0 - 10.5	(.28-.41)	20480.6
9.0 - 13.0	(.35-.51)	20481.6
11.5 - 15.5	(.45-.61)	20482.6
11.5 - 15.5	(.45-.61)	20483.6
14.0 - 18.0	(.55-.71)	20484.6
17.0 - 20.5	(.67-.81)	20485.6
20.0 - 25.0	(.79-.98)	20487.6
24.0 - 28.0	(.94-1.10)	20489.6
30.0 - 34.0	(1.18-1.34)	20490.6
32.0 - 36.0	(1.26-1.42)	20492.6
-	-	-
-	-	-

LOCKNUTS – Order Separately

Nickel Plated Brass

Temperature Range: -40 to 300°C (-40 to 572°F)

Size	Cat. No.	Std. Pk.	Size	Cat.No.	Std. Pak
PG7	23000.9	50	PG21	23005.9	25
PG9	23001.9	50	PG29	23006.9	20
PG11	23002.9	50	PG36	23007.9	10
PG13.5	23003.9	50	PG42	23008.9	5
PG16	23004.9	25	PG48	23009.9	5

See page 60 for additional information