

Panel Cut-Out

SCREW MOUNT FRONT OR REAR

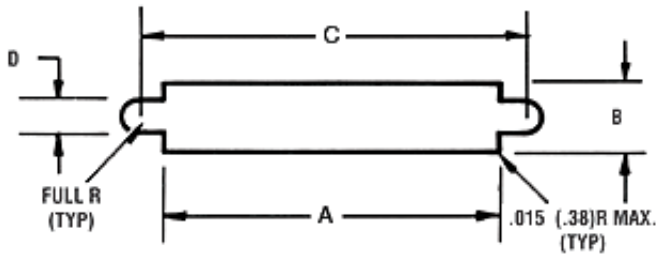

Recommended dimensions for front panel mount only.

Consult factory for information concerning rear panel mounting.

SIZE	A +.004 (.10) - .000	B MIN	C MIN	D +.005 (.13) - .000
-9	.438 (11.13)	.313 (7.95)	.570 (14.48)	.089 (2.26)
-15	.588 (14.94)	.313 (7.95)	.720 (18.29)	.089 (2.26)
-21	.738 (18.75)	.313 (7.95)	.870 (22.10)	.089 (2.26)
-25	.838 (21.29)	.313 (7.95)	.970 (24.64)	.089 (2.26)
-31	.988 (25.10)	.313 (7.95)	1.120 (28.45)	.089 (2.26)
-37	1.138 (28.91)	.313 (7.95)	1.270 (32.26)	.089 (2.26)
-51	1.088 (27.64)	.313 (7.95)	1.220 (30.99)	.089 (2.26)
-100	1.518 (38.56)	.404 (10.26)	1.805 (45.85)	.145 (3.68)

Dimensions subject to change.

[>> close window](#)